



First Choice
Group

SPARE PARTS DIAGRAM FOR

Lincat

Water Boiler
(2010)

EB3,EB4,EB6,EB6T
(Discontinued August 2008)
EB3F,EB4F,EB6F,EB6TF

First Choice Group
Blakeney Way, Kingswood Lakeside
Cannock, Staffs, WS11 8LD
TEL: 01543 577778 FAX: 01543504141
Email: enquires@firstchoice-cs.co.uk
Web: www.firstchoice-cs.co.uk

Parts No	Description	Used On
BE16	Tap Bezel	EB3, EB4, EB6 (Post March 2000)
BE17	Neon Bezel	EB3, EB4, EB6 (Post March 2000)
BR49	Wall Brackets	EB3F, EB4F
BR50	Wall Brackets	EB6F, EB6TF
CF1	Carbon-x Filter Head	EB3, EB4, EB6
CFC1	Carbon-x Filter Cartridge	EB3, EB4, EB6
FHK01	Fitting kit for CF1	EB3, EB4, EB6
CO111	Contactora	EB6, EB6T, EB4F
CO112	Contactora	EB4
DV01	Drain Valve	EB3, EB4, EB6 (Post March 2000)
DV02	Drain Valve	EB3F, EB4F, EB6F, EB6TF
EBM05	Outer Lid	EB3F, EB4F
EBM07	Outer Lid	EB6F, EB6TF
EL119	3kW Element	EB3, EB6 (Pre March 2000)
EL178	3kW Element	EB3, EB6, EB6T (Post March 2000)
EL179	4.5kW Element	EB4 (Post March 2000)
EL235	3kW Element	EB3F, EB6F, EB6TF
EL241	4.5kW Element	EB4F
FE01	Feet	EB3, EB4, EB6 (Post March 2000)
FC02	Filter Cartridge	EB3F, EB4F, EB6F, EB6TF
FH02	Filter Head	EB3F, EB4F, EB6F, EB6TF
GA05	Element Gasket	EB3, EB4, EB6 (Post March 2000)
GA38	Tank seal	EB6, EB6T (Post March 2000)
GA39	Tank seal	EB4 (Post March 2000)
GA40	Tank seal	EB3 (Post March 2000)
GA48	Lid Gasket (2 per unit)	EB3F, EB4F
GA51	Lid Gasket (2 per unit)	EB6TF
LA168	Lid Assembly c/w Blue Bezel	EB3 (Post March 2000)
LA169	Lid Assembly c/w Blue Bezel	EB4 (Post March 2000)
LA170	Lid Assembly c/w Blue Bezel	EB6, EB6T (Post March 2000)
LE18	Lower Level Sensor (22cm)	EB3 (Post Serial No 118806), EB4, EB6, EB6T (Post March 2000)
LE19	Lower Level Sensor	EB4 (Pre March 2000)
LE20	Lower Level Sensor	EB6 (Pre March 2000)
LE21	Upper Level Sensor	EB3, EB4, EB6
LE47	Level Sensor Insulators	EB3F, EB4F, EB6F
LE48	Upper Level Sensor (2 per unit-1 x level 1 x scale detector)	EB3F, EB4F, EB6F
LE49	Lower Level Sensor	EB3F, EB4F, EB6F
LI03	Inner Lid	EB3 (Post March 2000)
LI04	Inner Lid	EB4 (Post March 2000)
LI06	Inner Lid	EB6 (Post March 2000)
LI52	Inner Lid	EB6F, EB6TF
LI53	Inner Lid	EB3F, EBF
NE02	Round Green Neon	EB3, EB4, EB6 (Post March 2000)
PI12	Flexible Hose	All Models
PD02	Protective Device c/w Heatsink	EB3, EB4, EB6 (Post March 2000)
PL144	Plug & Lead	EB3
PL202	Plug & Lead	EB3F
PR10	Printed Circuit Board	EB3, EB4, EB6
PR64	Printed Circuit Board	EB3F
PR65	Printed Circuit Board	EB4F
PR66	Printed Circuit Board	EB6F, EB6TF
SL15	Black Tap	EB3, EB4, EB6
SL16	Tap Spindle (Stem)	All Models
SL18	Tap Seal	All Models
SL19	Tap Spring	All Models
SL20	Tap Union Nut	All Models

SL21	Tap Circlip	All Models
SL22	Tap Upper (Black incl. SL18, SL19, SL16 & Handle)	EB3, EB4, EB6 (Pre March 2000)
SL27	Complete Tap (Blue)	EB3, EB4, EB6 (Post March 2000)
SL28	Tap Upper (Blue incl. SL18, SL19, SL16 & Handle)	EB3, EB4, EB6(Post March 2000)
SL29	Complete Tap	EB3F, EB4F, EB6F, EB6TF
SO1	Solenoid Valve c/w Inner Hose	EB3, EB4, EB6 (Post March 2000)
SO23	Solonoid Valve	EB3F, EB4F, EB6F, EB6TF
SW53	Green Neon Rocker Switch	EB3, EB4, EB6 (Post 1996-2000)
STA01	Spillage Tray c/w Grid	EB3 (Post March 2000)
STA02	Spillage Tray c/w Grid	EB4 (Post March 2000)
STA03	Spillage Tray c/w Grid	EB6 (Post March 2000)
STA04	Spillage Tray c/w Grid	EB6T (Post March 2000)
STA05	Spillage Tray c/w Grid	EB3F, EB4F
STA06	Spillage Tray c/w Grid	EB6F
STA07	Spillage Tray c/w Grid	EB6TF
TA30	Inner Tank	EB3F, EB4F
TA31	Inner Tank	EB6F
TA32	Inner Tank	EB6TF
TA81	Inner Tank	EB3 (Post March 2000)
TA82	Inner Tank	EB4 (Post March 2000)
TA83	Inner Tank	EB6 (Post March 2000)
TA84	Inner Tank	EB6T (Post March 2000)
TH09	Control Thermostat	EB3, EB4, EB6
TH87	95 Deg c Cutout (Over Temp./Steam)	EB3F, EB4F, EB6F, EB6TF
TH88	120 Deg c Cutout (Boil Dry)	EB3F, EB4F, EB6F, EB6TF
TH90	Thermistor	EB3F, EB4F,EB6F, EB6TF

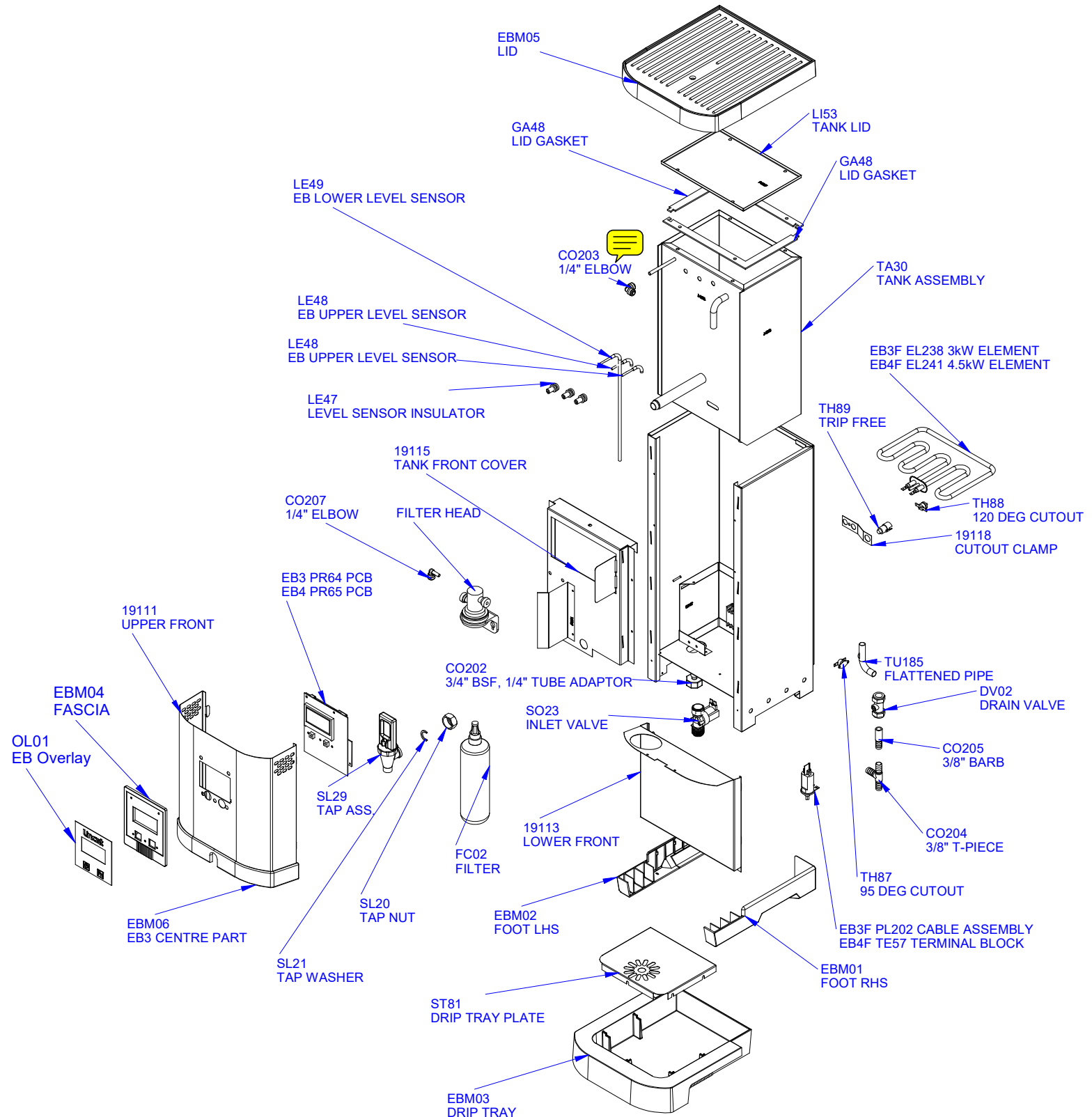

NOTE: EB4F USES CONTACTOR CO111

TH90 THERMISTOR NOT SHOWN
 WL01 SENSOR LOOM NOT SHOWN